

RSF1041LC 1U Vented Sliding Shelf Installation

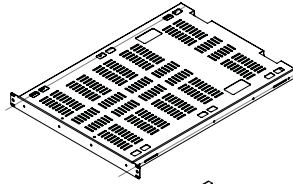

Included in this package

(1) RSF1041 Shelf ❶



(14) M4 x 8 Screws



(2) Ear Brackets ❷

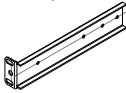

(4) #10-32 x 5/8 Rack Screws



(2) Sliding Rail ❸

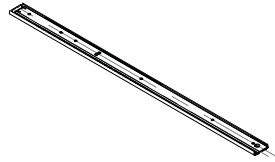

(4) #12-24 x 5/8 Rack Screws



Installation Steps

Step 1. You need to remove travel slide first. Hold the main slid while you pull the travel slide out. When you hear a clicking sound, push the latch and pull to release the travel slide.

Step 2. Carefully align the mounting holes on the front bracket and rear brackets ❷ to the mounting holes on a 4 post rack. Use either (4) 10-32 pan head screw or (4) 12-245 pan head screws to secure the rear brackets ❷ to the rack.(Figure 2)

Step 3. Attach the main rail section to a set of front ❷ and rear brackets ❷ as shown on the right.

Step 4. Use (8) M4 pan head screws to secure the main rail section to the brackets.

Step 5. Attach the travel slide section of the sliding rail to each side of the main shelf. (Figure 3)

Step 6. Use (6) M4 pan head screws to secure the travel slide to the main shelf. (Figure 3)

Step 7. Carefully slide the main shelf unit into the main rail section as shown on .(Figure 4)

Step 8. Installation Complete.

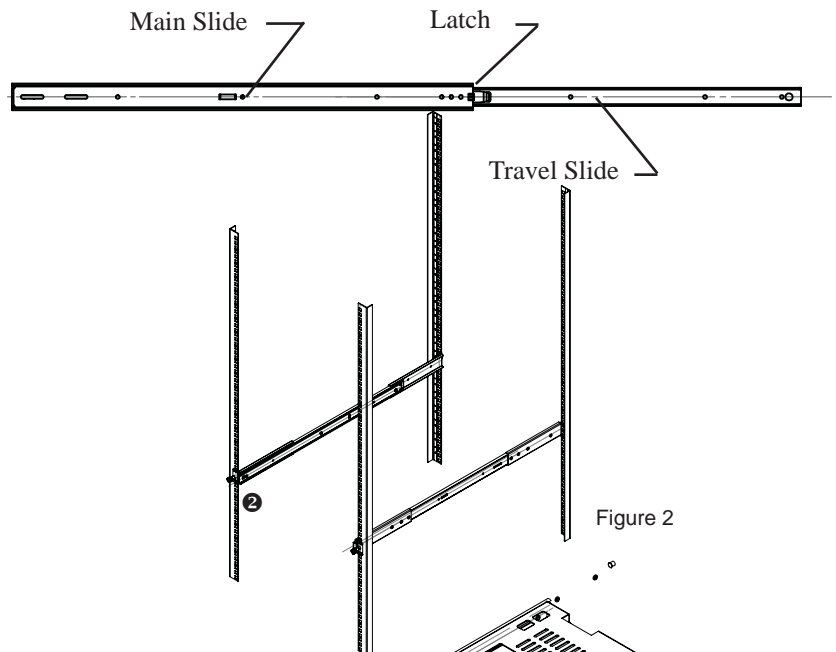

Figure 2

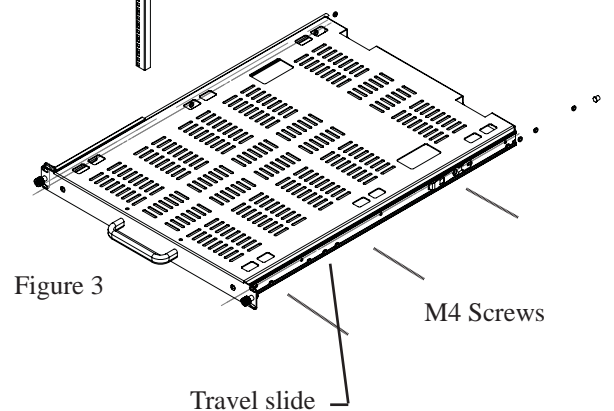

Figure 3

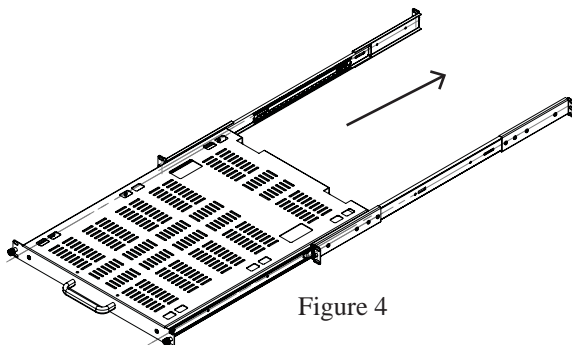

Figure 4